

# A1 Birtley to Coal House

**Scheme Number: TR010031**

## 6.2 Environmental Statement – Figures Figure 6.2 Heritage Constraints Plan - Non-Designated Sites

APFP Regulation 5(2)(a)

Planning Act 2008

Infrastructure Planning (Applications: Prescribed Forms  
and Procedure) Regulations 2009

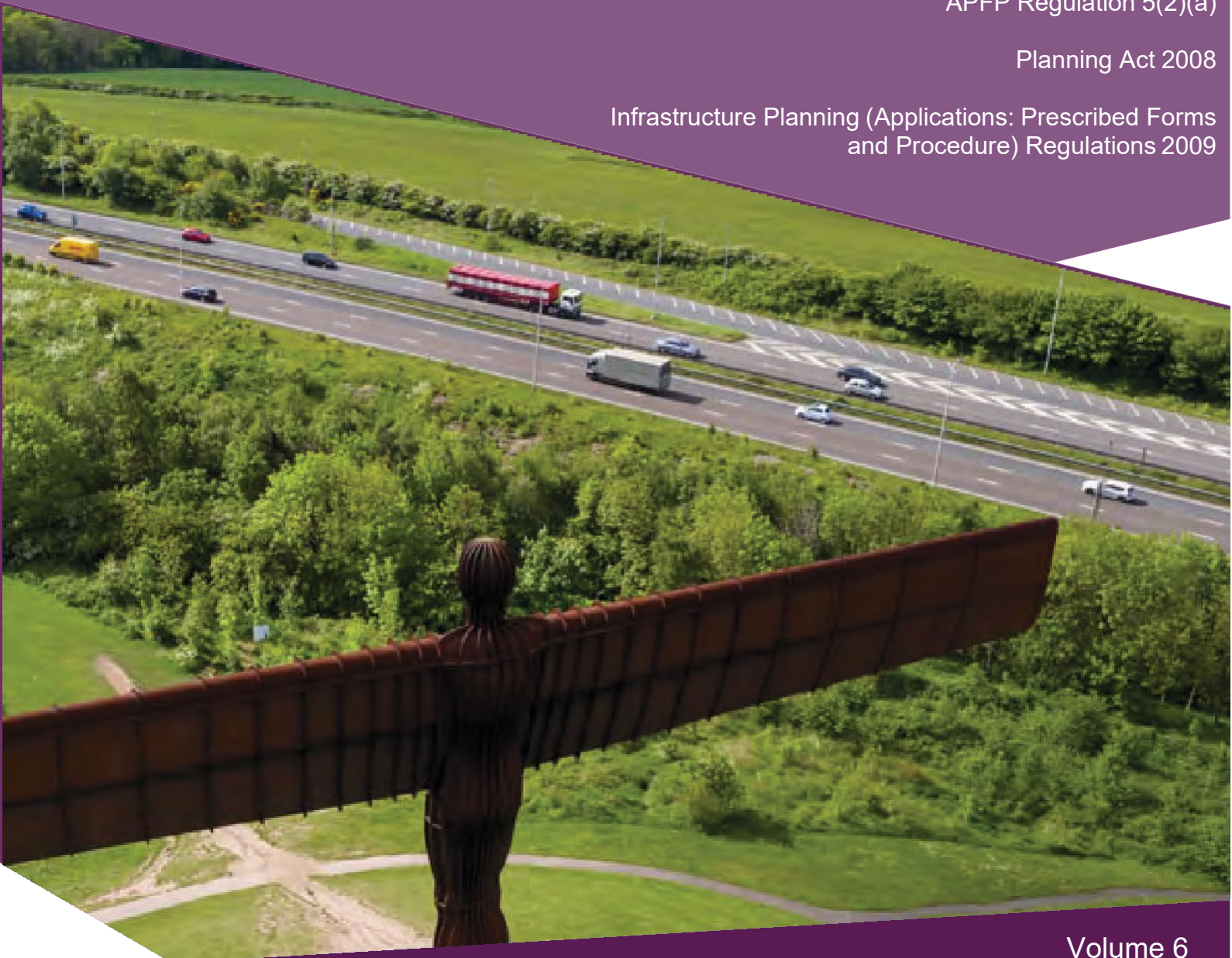

Infrastructure Planning

Planning Act 2008

**The Infrastructure Planning  
(Applications: Prescribed Forms and  
Procedures) Regulations 2009**

**A1 Birtley to Coal House  
Development Consent Order 20[xx]**

---

**Environmental Statement -  
Figures**

---

<b>Regulation Reference:</b>	APFP Regulation 5(2)(a)
<b>Planning Inspectorate Scheme Reference</b>	TR010031
<b>Application Document Reference</b>	TR010031/APP/6.2
<b>Author:</b>	A1 Birtley to Coal House Project Team, Highways England

<b>Version</b>	<b>Date</b>	<b>Status of Version</b>
Rev 0	14 August 2019	Application Issue

User Name: UKGDH001 Date Saved: 16/04/2019 10:34:58  
 Document Path: \\uk.wspgroup.com\central\data\Projects\700419\A1\BCH\PCF Stage 3 and 4\103 Shared\EI EIA and flood risk\01 Model\GIS\MXD\Environmental Statement\Figure 6.2 - Heritage Constraints Plan Non-Designated Sites.mxd

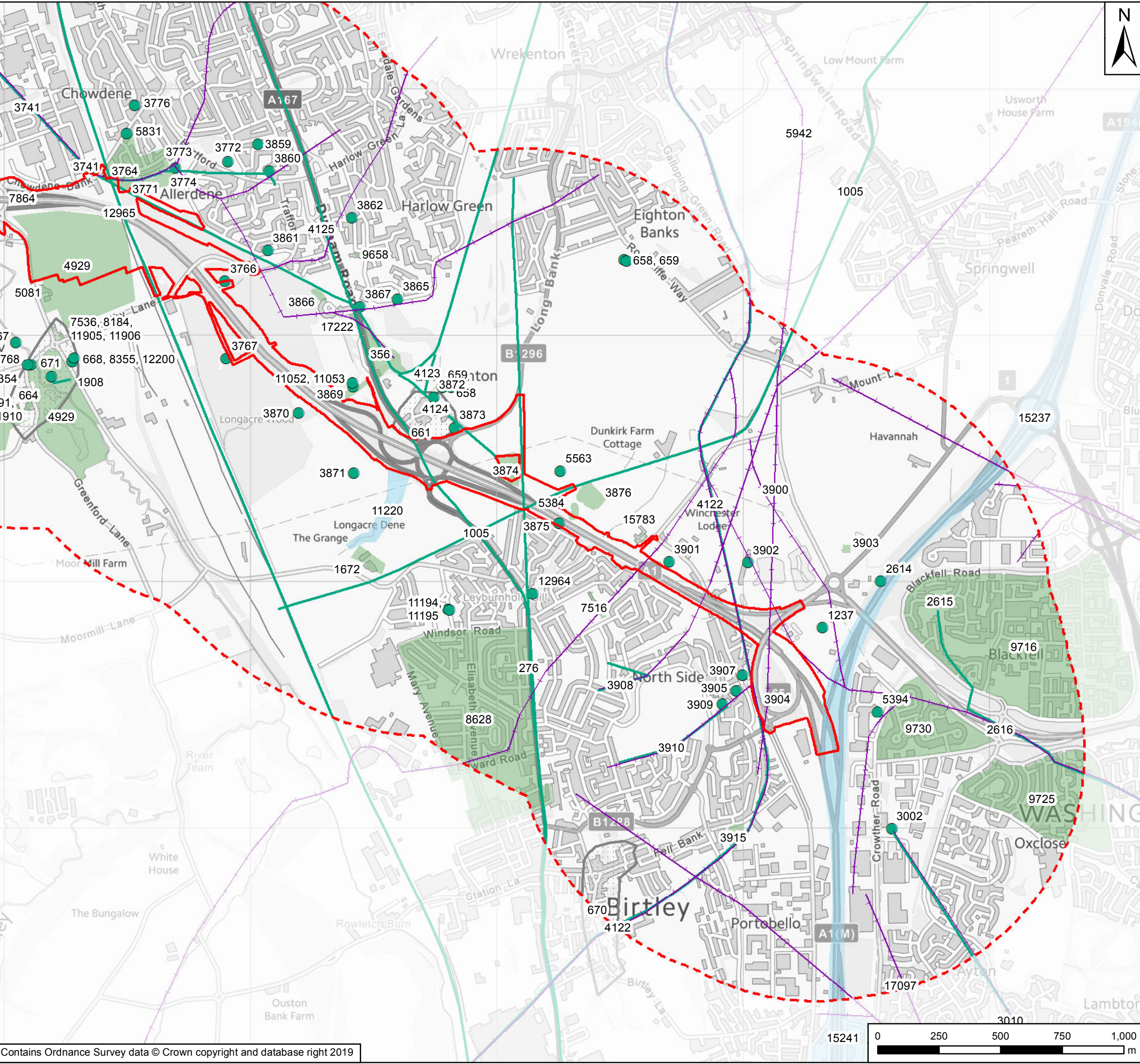

**Key**

- Scheme Footprint
- 1km Study Area
- Non-Designated Heritage Assets
- Non-Designated Heritage Assets
- Non-Designated Heritage Assets
- Non-Designated Heritage Assets
- Wagonways
- Site of Village

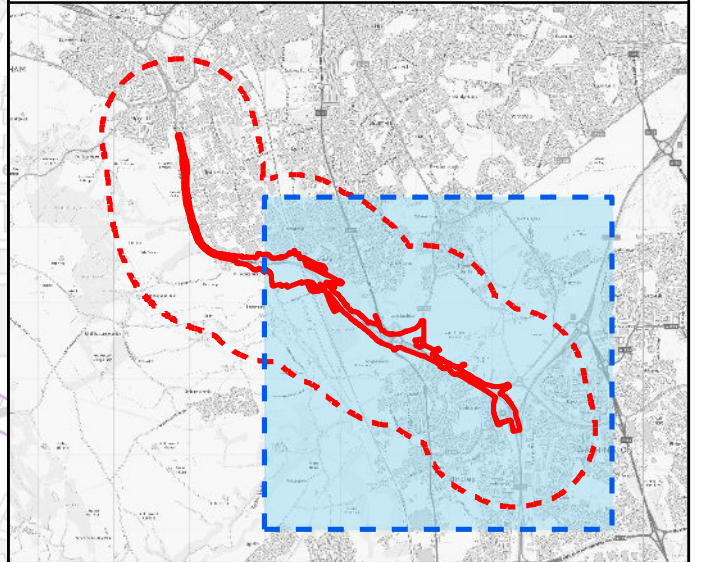

Rev	Date	Description	By	Chk'd	App'd
P03	Apr 2019	Third Issue	GH	AG	KS
P02	Mar 2019	Second Issue	GH	AG	KS
P01	Dec 2018	First Issue	GH	AG	NJA

PINS Reference Number: **TR010031**



Project Title: **A1 Birtley to Coal House Scheme**

Drawing Title: **Figure 6.2.1 Heritage Constraints Plan  
Non-Designated Heritage Assets  
Regulation 5(2)(m)**

Scale	Drawn	Checked	Approved	Authorised
1:15,000	GH	AG	KS	NJA

Original Size	Date	Date	Date	Date
A3	Dec 2018	Dec 2018	Dec 2018	Dec 2018

Drawing Number	Originator	Volume	Revision
HE551462	WSP	6.2	P03

Contains Ordnance Survey data © Crown copyright and database right 2019

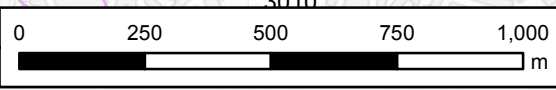

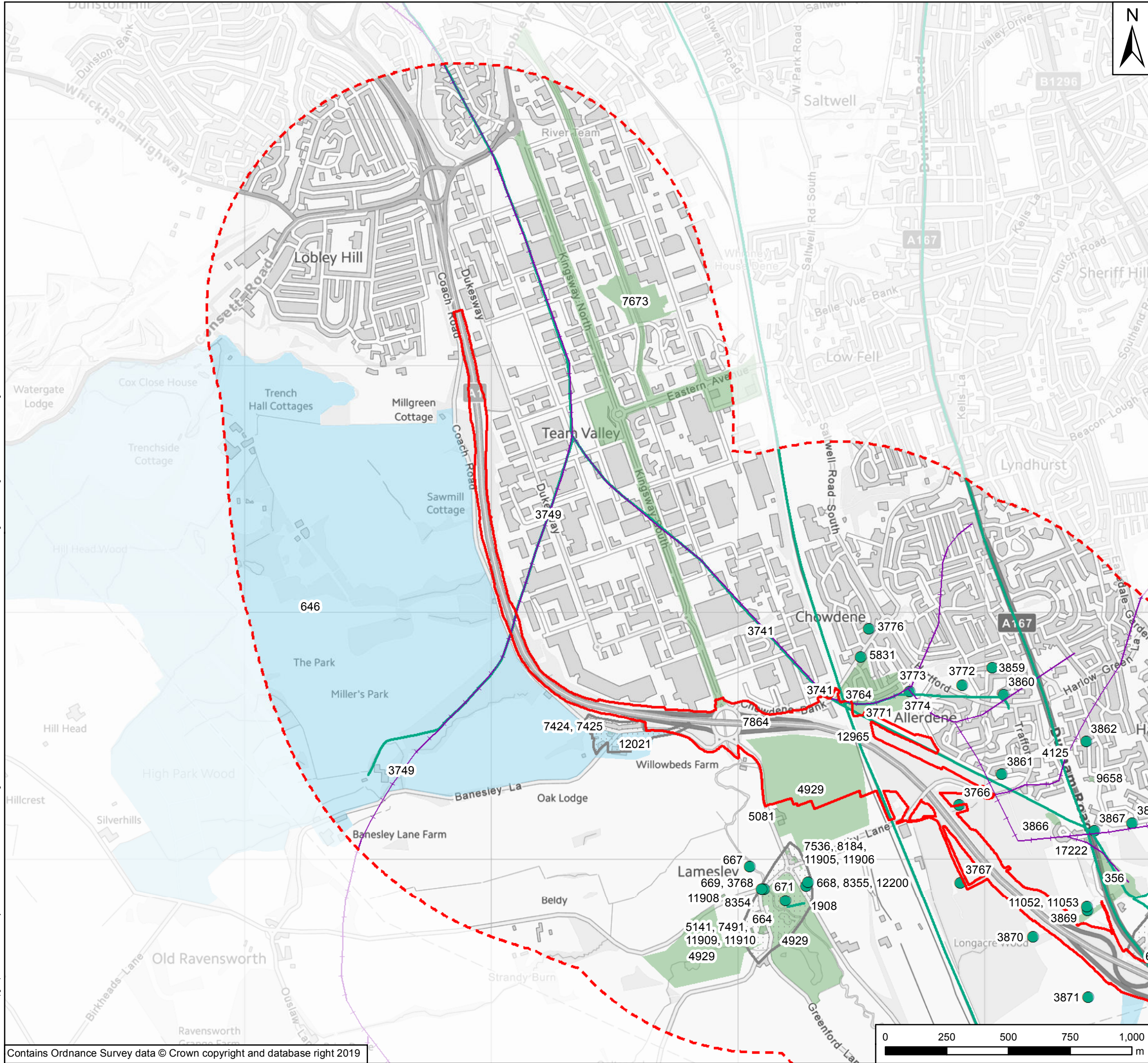

**Key**

- Scheme Footprint
- 1km Study Area
- Non-Designated Heritage Assets
- Non-Designated Heritage Assets
- Non-Designated Heritage Assets
- Non-Designated Heritage Assets
- Wagonways
- Site of Village

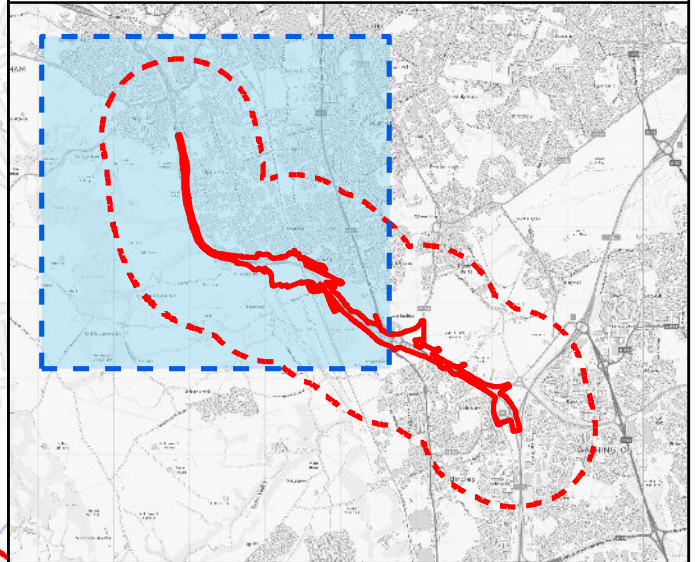

P03	Apr 2019	Third Issue	GH	AG	KS
P02	Mar 2019	Second Issue	GH	AG	KS
P01	Dec 2018	First Issue	GH	AG	NJA
Rev	Date	Description	By	Chk'd	App'd
Suitability					Status

PINS Reference Number: TR010031

Client:

Project Title: A1 Birtley to Coal House Scheme

Drawing Title: Figure 6.2.2 Heritage Constraints Plan  
Non-Designated Heritage Assets  
Regulation 5(2)(m)

Scale	1:15,000	Drawn	GH	Checked	AG	Approved	KS	Authorised	NJJA
Original Size	A3	Date	Dec 2018	Date	Dec 2018	Date	Dec 2018	Date	Dec 2018

Drawing Number HE PIN	HE551462	Originator	WSP	Volume	6.2	Revision	P03
PW Stage Code							

Section	Type	ID	Direction	Type	Role	Number
---------	------	----	-----------	------	------	--------

If you need help accessing this or any other Highways England information, please call **0300 470 4580** and we will help you.

---

© Crown copyright 2019.

You may re-use this information (not including logos) free of charge in any format or medium, under the terms of the Open Government Licence. To view this licence:

visit [www.nationalarchives.gov.uk/doc/open-government-licence/](http://www.nationalarchives.gov.uk/doc/open-government-licence/)

write to the **Information Policy Team, The National Archives,**

**Kew, London TW9 4DU**, or email

[psi@nationalarchives.gsi.gov.uk](mailto:psi@nationalarchives.gsi.gov.uk).

This document is also available on our website at [www.gov.uk/highways](http://www.gov.uk/highways)

If you have any enquiries about this document [A1BirtleytoCoalhouse@highwaysengland.co.uk](mailto:A1BirtleytoCoalhouse@highwaysengland.co.uk) or call **0300 470 4580\***.

\*Calls to 03 numbers cost no more than a national rate call to an 01 or 02 number and must count towards any inclusive minutes in the same way as 01 and 02 calls.

These rules apply to calls from any type of line including mobile, BT, other fixed line or payphone. Calls may be recorded or monitored.

Registered office Bridge House, 1 Walnut Tree Close, Guildford GU1 4LZ  
Highways England Company Limited registered in England and Wales number 09346363